

# Cordless Pet Grooming Vacuum

Model: BM5

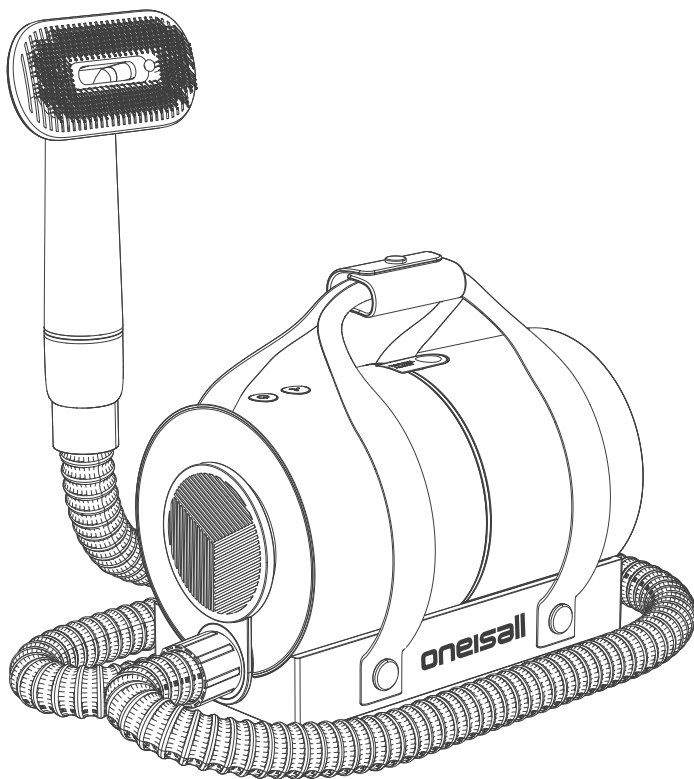

User Manual

# Safety Warnings

---

- Read Before Use: Before using the pet hair vacuum, read all safety and operating instructions.
- Supervision: This appliance can be used by children aged from 8 years and above and persons with reduced physical, sensory or mental capabilities or lack of experience and knowledge if they have been given supervision or instruction concerning use of the appliance in a safe way and understand the hazards involved. Children shall not play with the appliance. Cleaning and user maintenance shall not be made by children without supervision.
- Cord Management: **If the supply cord is damaged, it must be replaced by the manufacturer, its service agent or similarly qualified persons in order to avoid a hazard.**
- Do not use to suck up water (for vacuum cleaners only).
- Please do not disassemble the product, the wrong assembly method may cause electric shock or fire. Please contact our company if maintenance is needed.
- Do not immerse in water for cleaning.
- The hose should be checked regularly and must not be used if damaged.
- Please keep the dust cup and filter clean
- The appliance is only to be used with the power supply unit provided with the appliance.
- Please do not inhale flammable or combustible liquids such as gas o-line; In addition, please do not use the machine in or near an environment with flammable or combustible gases.
- Do not use it while smoking or working with other high-temperature items (matches, hot ash, etc.).
- Please do not put things into the opening or block the opening. Please unplug the power cord when you need to change the parts or conduct maintenance.
- Please do not use or keep it outdoors or in other wet places. Please do not use products with fragrance as the fragrance may contain flammable chemicals.



# Use Precautions

---

DO NOT operate with wet hands or unplug the power cord to avoid electric shock.

DO NOT smoke or use other flammable material. Please do not use the machine in or near an environment with flammable or combustible gases.

There may be a strange smell during the first use; however, it will not cause adverse effects on the body and will disappear after a while. If the scorching smell persists, stop using it immediately!

Please keep the dust cup and filter clean.

If the dust cup and filter are used while dirty, they may cause product issue.

During maintenance, turn off the power supply and unplug the power cord before proceeding.

If the power is turned on for maintenance, it will cause electric shock, unexpected accidents, or injury.

The product will stop working when the temperature rises abnormally.

In case of abnormal heating of the motor, stop using it immediately.

If the suction opening is blocked, please stop using it immediately.

Take out the dust cup and clean the inlet and filter, then open it again after 60 minutes.

Please be sure to install and use the filter.

If you remove the filter, it will damage the motor.

# Use Precautions

---

Package List	01
Product Overview	02
How to Do if My Pets Get Nervous?	03
Charging Indication	04
Start to Vacuum Hair	05
Tips for Accessories Option	07
Maintenance	11
QA	13
Specifications	14
Contact Us	15
GPSR Product Information	16



oneisall support



Tutorial Video

# Package List

---

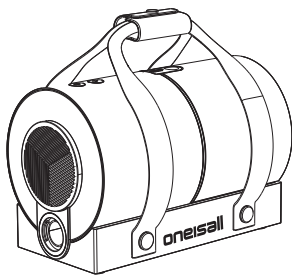

Main Vacuum Machine x1



Vacuum Hose

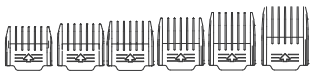

(3-6-9-12-18-24mm)Guide combs x 6



Pet clippers



Nail grinder head



Paw trimmer head



Pin brush



Long narrow nozzle



Deshedding brush



Storage bag



Clean brush

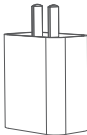

Adapter



Lubrication oil



USB charging cord

# Product Overview

Handle

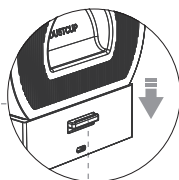
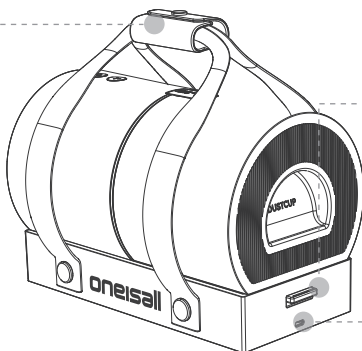

Press Down the Dust Cup Open Button

Charging port

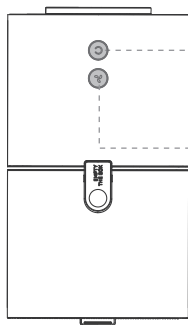

On/off Button

Long press the power button 3 seconds to turn on, press once button turn off

Speed Adjustment Button

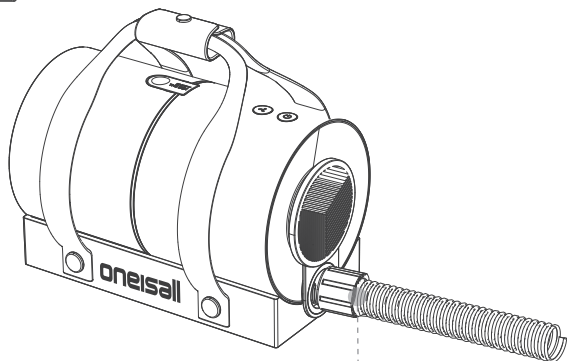

Vacuum Hose

# How to Do if My Pets Get Nervous?

---

**If your pet is nervous about the noise or the air flow, you may need to let him get used to the machine at first.**

1. It is recommended to fully charge the new machine before use.

(Charge your machine with our charger)

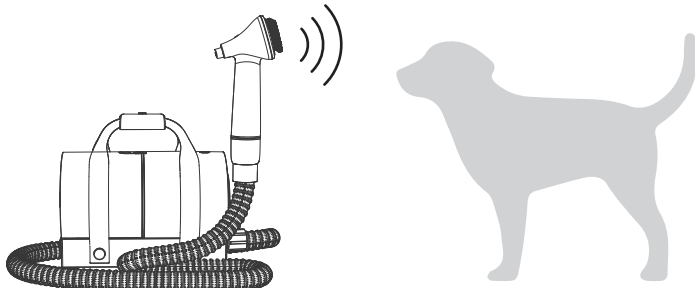

2. Treat your pet with snack.

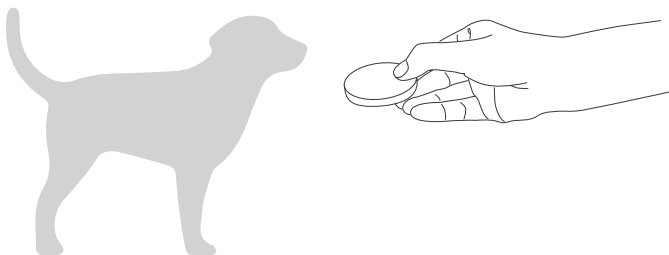

3. Start to use the vacuum. If your pet still get nervous, try to repeat 1-2 to let him know that this machine would not do harm to him.

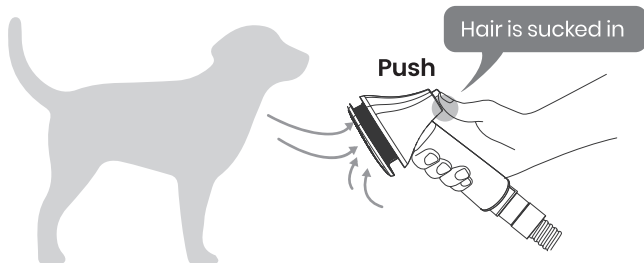

# Charging Indication

Insert the type-c port into the charging port.  
Charging time is 4 hours, max gear working time lasts for 30 minutes

1. It is recommended to fully charge the new machine before use.

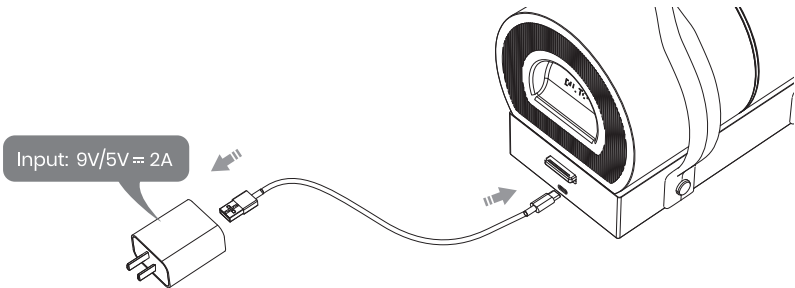

2. Battery Status Indicator Light.

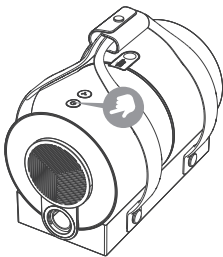

Battery State	The light	Indicates
battery level<20%	Yellow light always on	Gear Button
battery level<10%	Red light always on	Gear Button
battery level between 0-30%	Blue light flashing	First gear
battery level between 31%-70%	First gear blue light always on, second gear blue light flashing	
battery level between 71%-99%	First and second gears blue light always on, 3 gears blue light is flashing	
battery level 100%	Blue light always on	First,second and three gears

# Start to Vacuum Hair

1.Insert the hose into the main vacuum machine port, tighten clockwise to access the main unit

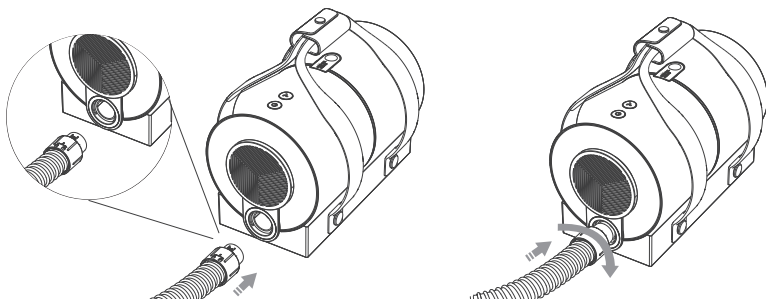

2.Install suction head accessories.

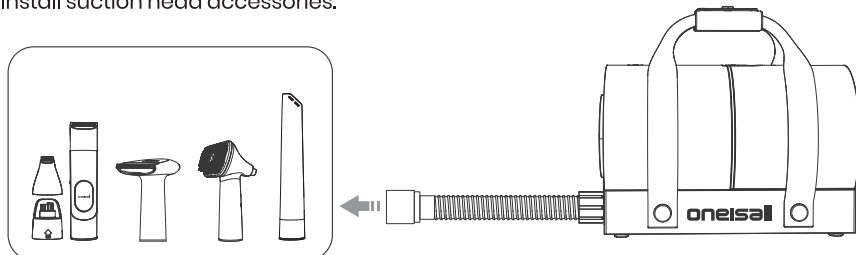

3. (1) Long press the power button 3 seconds to turn on, press once button turn off.



3. (2) Start suctioning, brushing or trimming pet hair as your

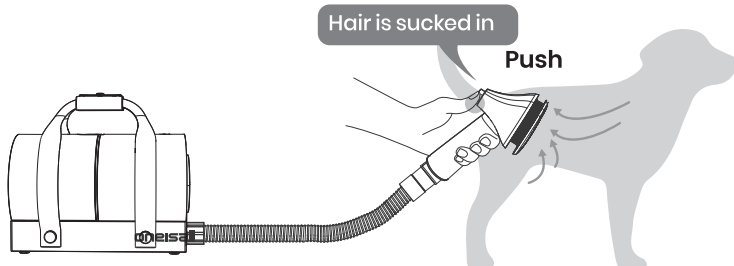

## **NOTE**

1. Our machine is cordless and don't need to be connected to the power to be used
2. Our machine couldn't be used while charging

4. Select the speed you need, We suggest starting with low mode for first-time use.

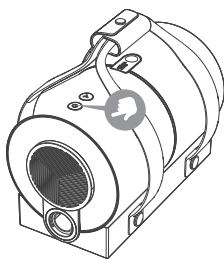

5. Groom your pet.

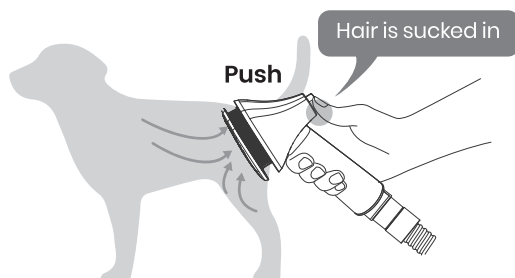

6. Clean the dust cup.

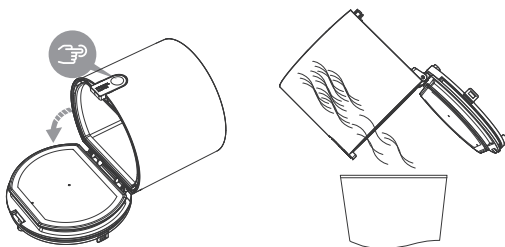

## **NOTE**

There are 3 Cleaning Modes: low, middle, high mode. We suggest starting with the low mode for first-time use as your pet will slowly get used to the noise.



## Tips for Accessories Option

---

### Pin brush

A larger area of comb teeth is suitable for cats matted long hair, used to remove the loosen hair and the dander inside the coats. Making the hair more fluffy and healthy.

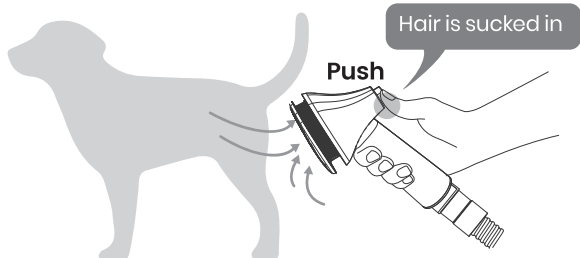

### Deshedding brush

Curved comb teeth can fit the back and head well. Used to remove the pet's long and unnecessary thick hair.

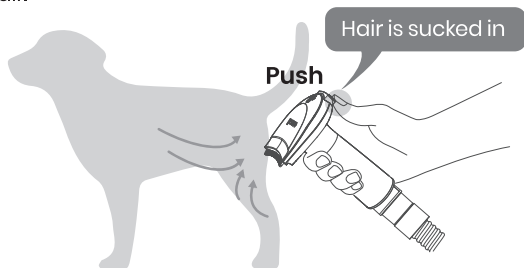

### Pet Clippers

- 1) Used to trim the pet's hair without leaving a mess as the hair will not fly around. While cutting, it suctions the cut hair!
- 2) Rechargeable electric clippers can be separately used.

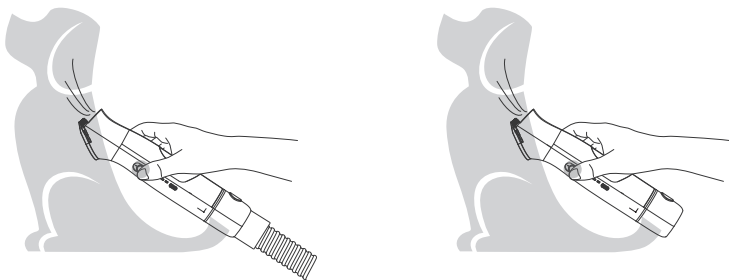

Note: Pet clippers need to be charged before use

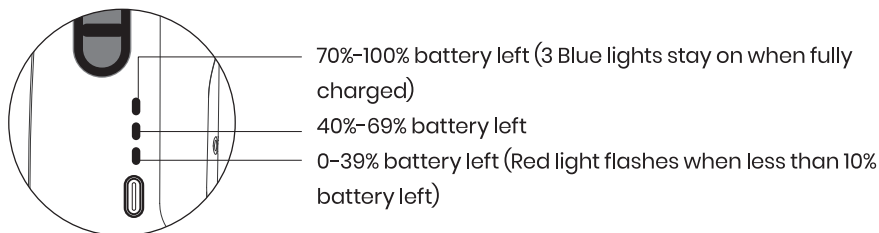

## 1. Tips for Insall Guide Comb

- (1) Choose the guide comb according to the length of pet hair you want to leave.
- (2) The guide comb (3mm/6mm/9mm/12mm/18mm/24mm) is applicable for grooming different hair lengths.
- (3) You can put it in our storage bag to prevent it from getting lost.

- The guide comb set is small; keep it stored properly when it is not in use.



3mm (1/8")



6mm (1/4")



9mm (3/8")



12mm (1/2")



18mm (3/4")



24mm (4/4")

## Install the guide comb

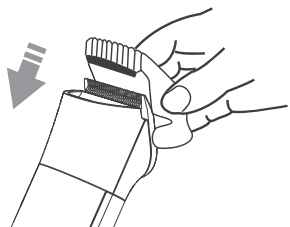

## Remove the guide comb

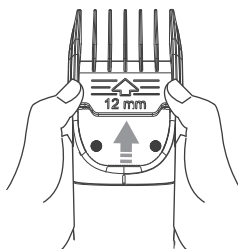

## 3. Remove the cutter head

Pull out upwards

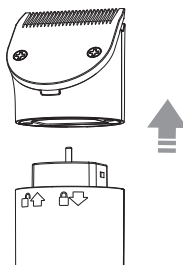

## Pet Paw Trimmer

Used to groom pet's paws, eyes, ears, face, and rump hair.



## **NOTE**

During use, pay attention to the cutting edge and position, do not use excessive force as it causes skin irritation.

### **Pet Nail Grinder**

Used to groom your pet's nails.



## **NOTE**

Be careful on the soft parts of the pet's skin, and do not use excessive force as it causes skin irritation.

### **Long narrow nozzle**

Used to clean carpet, sofa corners, car, cat tree and cat nest.

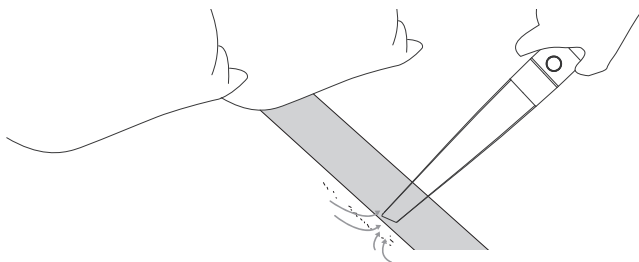

# Maintenance

## Cleaning the dust collection cup

1. Turn off the power.

Press the Dust Cup Open Button downward with your finger

2. Press the "EMPTY THE BOX" button and pour out the hairs

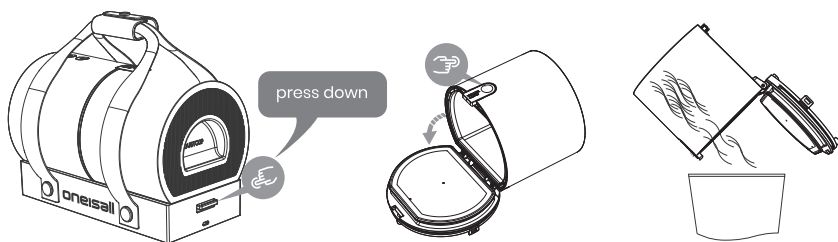

### ! NOTE

1. If the removed dust cup is cleaned with water or a wet cloth, be sure to install it after the dust cup is completely dry. Otherwise, it will damage the motor.
2. Please take dust cup lightly, if it drops will be damaged easily. If you have any problems with the cup, please contact us on Amazon or contact us email [support@oneisall.com](mailto:support@oneisall.com)

## Clean the blades of pet clippers

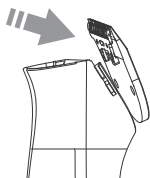

1. Push the blades out by hands.
2. Brush and wash the blades.
3. Dry the blades with cloth and drop oil.
4. Align the slot under the blades and press to install the blades.

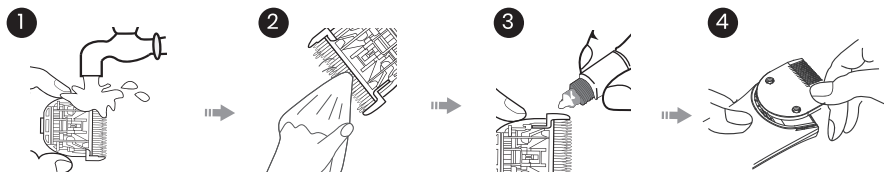

## Cleaning the HEPA & Sponge Filter

1. Remove the dust cup and remove the HEPA & sponge filter.

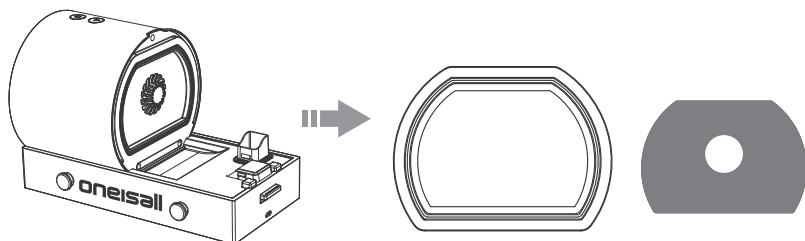

2. Clean them with brush

Note: Don't wash them with water.

3. Place the HEPA & sponge filter back into the machine.

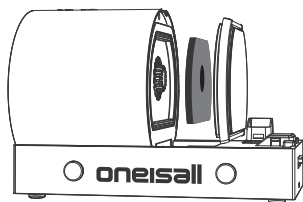
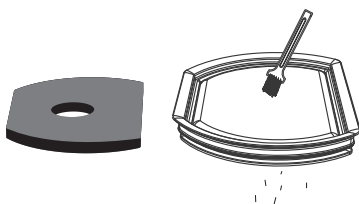

### **NOTE**

1. Remember to cut off the power supply when cleaning
2. Depending on the frequency of use and condition, the maintenance period is different, please clean it regularly.
3. Please make sure to install the screen after drying, the screen without drying will lead to electric shock and malfunction.

Problems	Possible Causes	Solutions
Cannot be turned on	Switch has not been turned on right	Long press the power button 3 seconds to turn on
Weak suction	Hose is clogged	Clean the hose and joint
	Dust cup is too full	Empty dust cup
	Filter is dirty	Clean filter
The pet clippers heats up during use	Debris stay in the internal parts of the clippers	Please remove the blade. Wash and oil
The hose is broken	Accidental damage	Remove the hoses and store them in the bag we provided.
	Bitten by pets at home	

- If the above solutions do not solve the problem, please stop using the product, and contact our customer support: **support@oneisal.com**

# Specifications

---

## The Main Machine

Input voltage	9V $\approx$ 2A
Rated power	90W
Hose length	59 inches
Dust cup capacity	2L/67.63OZ
Chaging Time	4h
Working Time	More than 30 mins
Size of the main machine	10.51x9.68x7.36 inch
Power cord length	1.8M/70.86inch
Maximum noise	55dB

## Pet Clippers

Input voltage	5V $\approx$ 2A
Rated power	5W
Charging time	About 3h
Working time	About 2h
Battery capacity	1400mAh



## Contact Us

---

### WE ARE READY TO HELP

Oneisall offers a standard 2-year warranty. If you have any issues with your Oneisall product, please do not hesitate to contact us. Be sure to include your proof of purchase, model number, and any relevant photos or videos in your message to expedite the process. Our Oneisall support team is available 7 days a week and will respond to your inquiry within 24 hours. Thank you for choosing Oneisall.

Please note that the Oneisall warranty does not apply to used products or purchases made from unauthorized sellers. It's important to be aware that the warranty also does not cover consumable parts such as blades, guards, filters, brushes, and similar items. These parts may require regular replacement or maintenance.

✉ [support@oneisall.com](mailto:support@oneisall.com)

📞 +1 877-522-8578 (US) Mon-Fri 8am-5pm (PST)

🌐 [www.oneisall.com](http://www.oneisall.com)



Guide video



@Oneisall Official

# GPSR Product Information

---



Name: Apex CE Specialists GmbH  
Add: Grafenberger Allee 277-287,40237 Düsseldorf,DE  
Contact Person: Wells Yan  
Tel: +353212066339  
E-Mail: Info@apex-ce.de



Name: APEX CE SPECIALISTS LIMITED  
Add: 6f East Union Street, Manchester, England, M16 9AE  
Contact: Wells  
Tel: +441616371080  
E-Mail: Info@apex-ce.com

## GPSR-Manufacturer Info:

Business Name: chuzhouguanyidianzishangwuyouxiangongsi  
Manufacturer Address: CN, 239200, anhui, chuzhoushi, laianxian, xinzhenqingliuxilu, taixinxiangzhangyuan1dong1danyuan2403shi  
E-Mail: oneisallofficial@hotmail.com

Product Name: Cordless Pet Grooming Vacuum  
Brand: oneisall  
Product Model: BM5  
Input: 9V  2A  
Power: 90W





Any problems you have, please contact us :  
[support@oneisall.com](mailto:support@oneisall.com)



oneisall support



Tutorial Video